

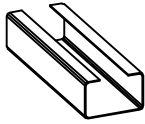

# Stock Secondary Framing

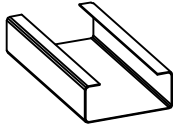

- 4"x2.5" 14ga Galvanized Cee - 4C14
- 20'-0" Length (4C14-PM/20)



- 6"x2.5" 14ga Galvanized Cee - 6C14
- 20'-0" Length (6C14-PM/20)

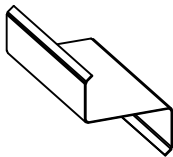

- 6"x2.5" 14ga Galvanized Zee - 6Z14
- 20'-0" Length (6Z14-PM/20)

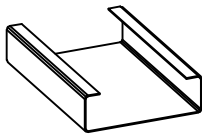

- 8"x2.5" 14ga Galvanized Cee - 8C14
- 20'-0" Length (8C14-PM/20)
  - 25'-0" Length (8C14-PM/25)
  - 30'-0" Length (8C14-PM/30)

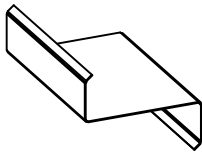

- 8"x2.5" 14ga Galvanized Zee - 8Z14
- 20'-0" Length (8Z14-PM/20)
  - 25'-0" Length (8Z14-PM/25)
  - 30'-0" Length (8Z14-PM/30)

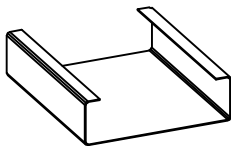

- 10"x3" 14ga Galvanized Cee - 10C14
- 20'-0" Length (10C14-PM/20)
  - 25'-0" Length (10C14-PM/25)
  - 30'-0" Length (10C14-PM/30)

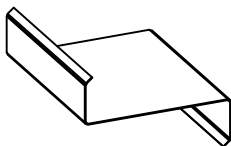

- 10"x3" 14ga Galvanized Zee - 10Z14
- 20'-0" Length (10Z14-PM/20)
  - 25'-0" Length (10Z14-PM/25)
  - 30'-0" Length (10Z14-PM/30)



# Stock Angles & Clips

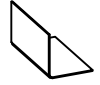

- L3x3x 14ga
- 3 3/4" Length (1030)
  - 5 3/4" Length (1031)

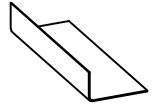

- L2x4x 16ga
- 20'-0" (BGA-PM)

## AL-1 CLIP

- L3"x6" x 6" x 12ga w/ 5/8"x1" Slots

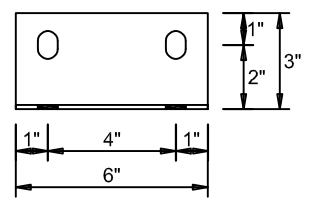
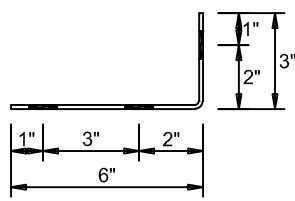
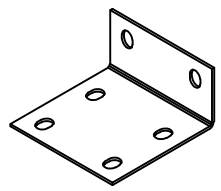

## AL-8 CLIP

- L3"x10 3/4" x 6" x 12ga w/ 5/8"x1" Slots

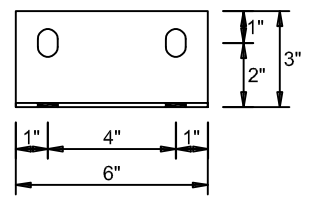
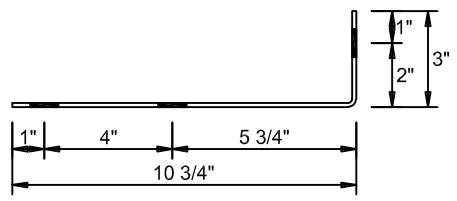
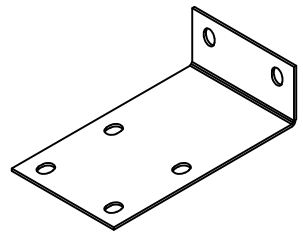

## DL-4 CLIP

- L3"x6" x 4" x 12ga w/ 5/8"x1" Slots

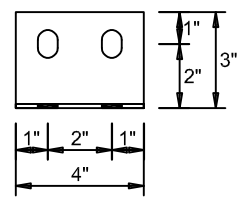
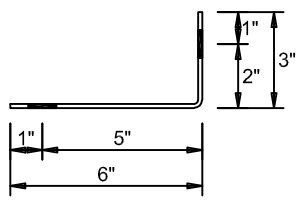
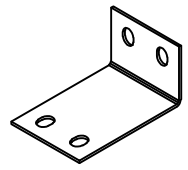



# Stock Angles & Clips

## DL-6 CLIP

- L6"x6" x 6" x 12ga w/ (2) 5/8"x1" Slots & 5/8"x3" Slots

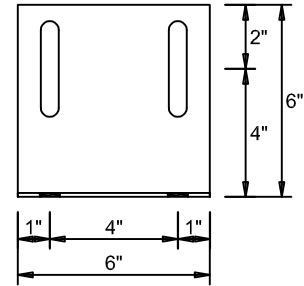
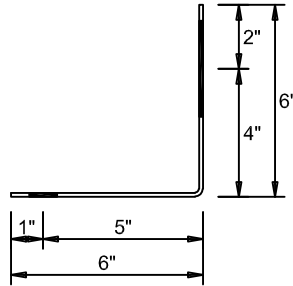
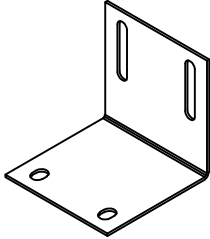

## AL-2 CLIP

- L3"x3" x 12" x 12ga w/ 5/8"x1" Slots

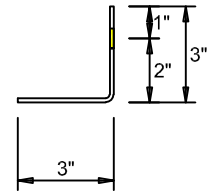
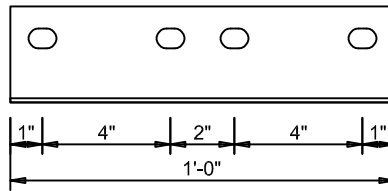
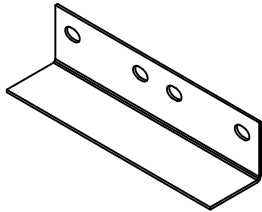

## PL-8G CLIP

- PL6"x10" x 12ga w/ 5/8"x1" Slots

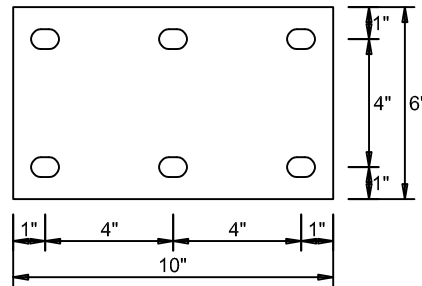
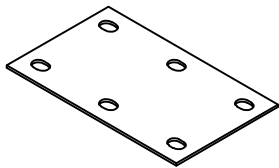

## PL-10G CLIP

- PL6"x11" x 12ga w/ 5/8"x1" Slots

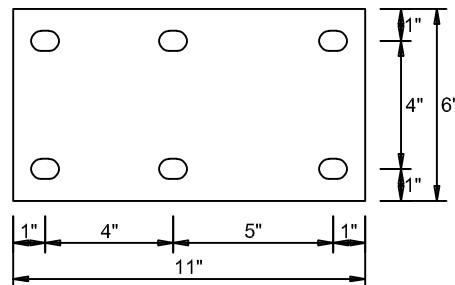
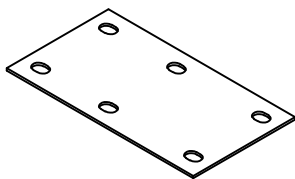



# Stock Angles & Clips

## AL-14 CLIP (Bolt on Clip for 4" & 6" Members)

- L3"x4" x 6" x 12ga w/ 5/8"x1" Slots

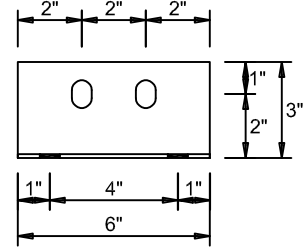
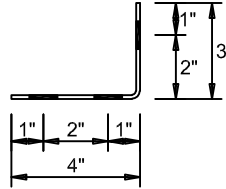
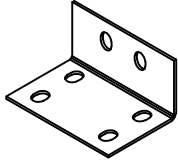

## AL-18 CLIP (Bolt on Clip for 6" and 8" Members)

- L3"x5" x 6" x 12ga w/ 5/8"x1" Slots

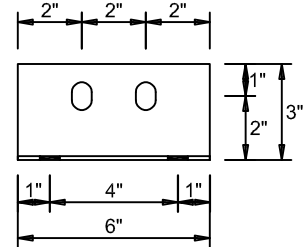
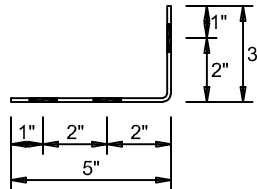
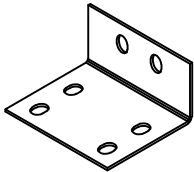

## AL-110 CLIP (Bolt on Clip for 10" Members)

- L3"x6" x 6" x 12ga w/ 5/8"x1" Slots

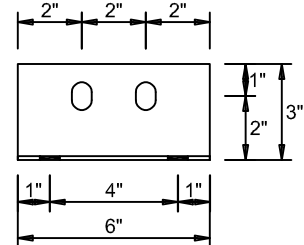
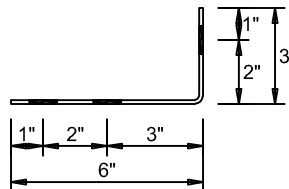
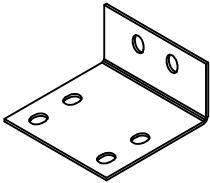

## AL-112 CLIP (Bolt on Clip for 12" Members)

- L3"x9" x 6" x 12ga w/ 5/8"x1" Slots

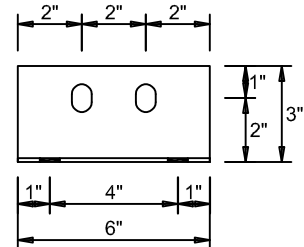
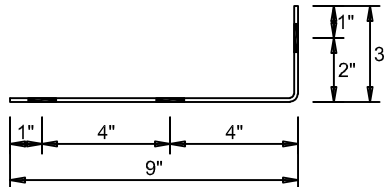
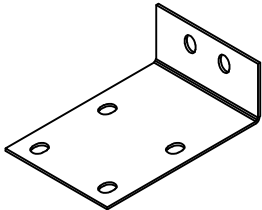

## AL-114 CLIP (Bolt on Clip for 14" Members)

- L3"x10" x 6" x 12ga w/ 5/8"x1" Slots

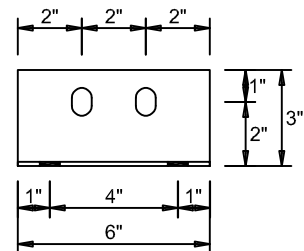
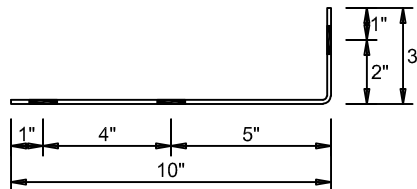
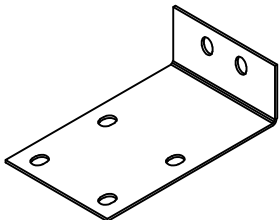



# Stock Clips and Mastic

## PL-1 CLIP (BARE STEEL, WELD ON)

- PL6"x 7"x 3/16" (4) 9/16"x1-1/16" Slots

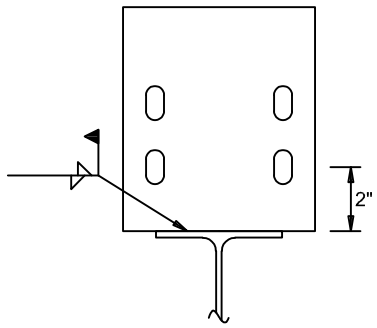
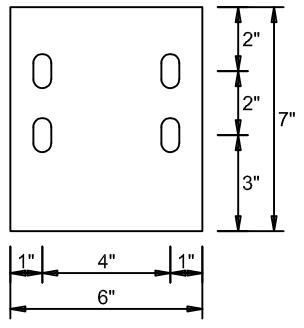

TYPICAL AT 8" MEMBERS

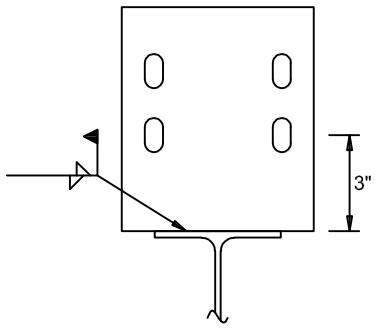

TYPICAL AT 10" MEMBERS

## 3/16" X 25'-0" Round Bead Mastic (BUTYL84004)



## 7/8" X 3/16" X 40'-0" Double Bead MBRV Butyl Tape (BUTLY89343)





# Stock Bolts and Screws



1/2" x 1-1/4" A307 Grade A Zinc Fin-Head Bolt



1/2" x 1-1/4" Grade 5 Zinc Bolt



1/2" Grade 5 Zinc Nut



1/2" Grade 5 Zinc Washer



- #12-14 x 3/4" Driller (Framing)
- 5/16" Hex Washer Head
  - Fasteners Sold in Quantities of 250 Only
  - Available in Plain or Painted

- #12-14 x 1-1/4" Driller (Framing)
- 5/16" Hex Washer Head
  - Fasteners Sold in Quantities of 250 Only
  - Available in Plain or Painted

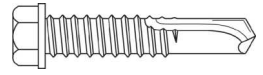

- #12-24 x 1-1/4" Heavy Tek Screw (Framing)
- 5/16" Hex Washer Head
  - Fasteners Sold in Quantities of 250 Only
  - Available in Plain or Painted

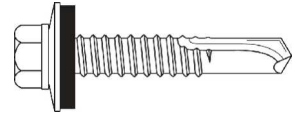

- #12-24 x 1-1/4" Heavy Tek Screw
- 5/16" Hex Washer Head w/ 5/8" O.D. Washer
  - Fasteners Sold in Quantities of 250 Only
  - Available in Plain or Painted

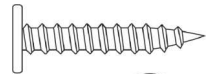

- #10-12 x 1" Pancake Wood Screw
- #2 Phillips Pancake Head
  - Fasteners Sold in Quantities of 250 Only
  - Available in Plain

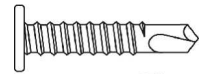

- #10-16 x 1" Pancake Driller
- #2 Phillips Pancake Head
  - Fasteners Sold in Quantities of 250 Only
  - Available in Plain

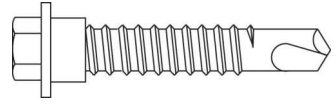

- #1/4-14 x 1-1/4" Shoulder Tek
- 5/16" Hex Washer Head
  - Fasteners Sold in Quantities of 250 Only
  - Available in Plain Only



# Stock Screws and SSR Clips



## #1/4-14 x 7/8" Ultimate Stitch Screw

- 5/16" Hex Washer Head w/ 5/8" O.D. Washer
- Fasteners Sold in Quantities of 250 Only
- Available in Plain Only

## #12-14 x 1-1/4" Ultimate Driller

- 5/16" Hex Washer Head w/ 5/8" O.D. Washer
- Fasteners Sold in Quantities of 250 Only
- Available in Plain Only

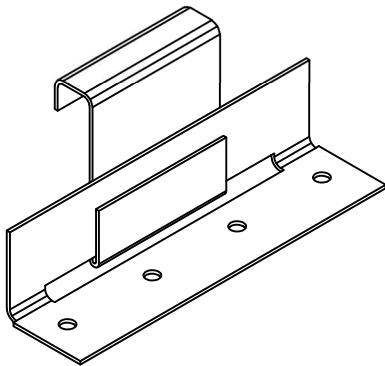

## SSR218 Floating Clip

- 2-3/8" Tall x 3" Wide Sliding Clip
- 22/18 Ga

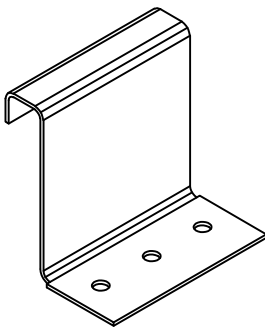

## SSR218 Fixed Clip

- 2" Tall x 3" Wide Fixed Clip
- 22 Ga